

FILED
92 JUL 27 AM 10:51
H.A.N. PENNY
COLUMBUS COUNTY R. OF D.
BY DB

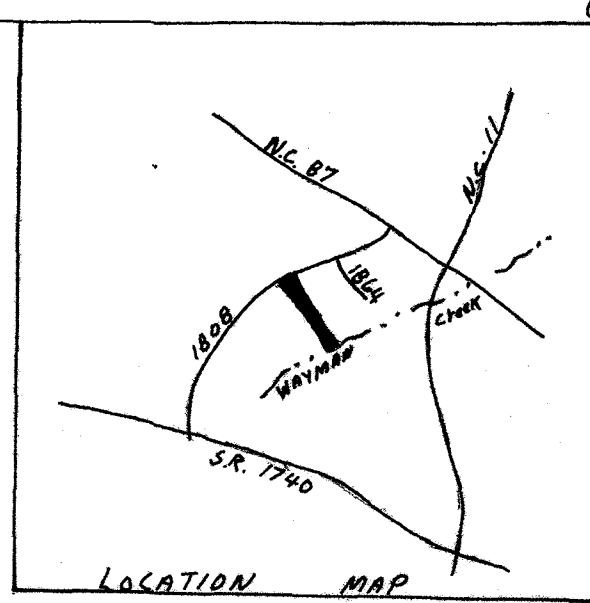

North Carolina
Columbus County
The foregoing or annexed certificate
of Donna H. Williamson
Notary Public
is/are certified to be correct. Presented
for registration and recorded in this
office in Book 54 Page 94
This the 27 Day of July 1992
at 10:51 o'clock A. M.
Register of Deeds
By Donna H. Williamson
Assistant/Deputy

I, DAVEY G. WILLIAMSON, REGISTERED LAND SURVEYOR NO. L-2826, CERTIFY TO ONE OR MORE OF THE FOLLOWING AS INDICATED THUS: OR
 A. THAT THIS IS A PLAN OF A SURVEY THAT CREATES A SUBDIVISION OF LAND WITHIN THE AREA OF A COUNTY OR MUNICIPALITY THAT HAS AN ORDINANCE THAT REGULATES PARCELS OF LAND;
 B. THAT THIS IS A PLAN OF A SURVEY THAT IS LOCATED IN SUCH PORTION OF A COUNTY OR MUNICIPALITY THAT IS UNREGULATED AS TO AN ORDINANCE THAT REGULATES PARCELS OF LAND;
 C. THAT THIS IS A PLAN OF AN EXISTING PARCEL OR PARCELS OF LAND;
 D. THAT THIS IS A PLAN OF A SURVEY THAT IS A RECOMBINATION OF PARCELS OF LAND OR A SURVEY THAT IS AN EXCEPTION TO THE DEFINITION OF A SURVEY;
 E. THAT THE INFORMATION AVAILABLE TO THIS SURVEYOR IS SUCH THAT I AM UNABLE TO MAKE A DETERMINATION TO THE BEST OF MY PROFESSIONAL ABILITY AS TO PROVISIONS CONTAINED IN (1) THROUGH (4) ABOVE.
Davey Williamson
DAVEY G. WILLIAMSON, REGISTERED LAND SURVEYOR NO. L-2826

MAP FOR
GEORGE W. ANDREWS
COLUMBUS CO, N.C.
RANSOM TWP.
DATE JULY 24, 1992
SCALE 1/100
DRN BY B.F. WILLIAMS
SURVEYOR
DAVEY WILLIAMSON
DELCO N.C.

04403

Columbus County, North Carolina
I, Davey G. Williamson certify that this map was drawn from an actual survey made under my supervision from data as noted, that the ratio of precision as calculated by D.M.D. is 1/1000; that this map was prepared in accordance with GS 47-30 as amended. Witness my hand and seal this 27 day of July 1992
Davey Williamson
Registered Land Surveyor (L-2826)

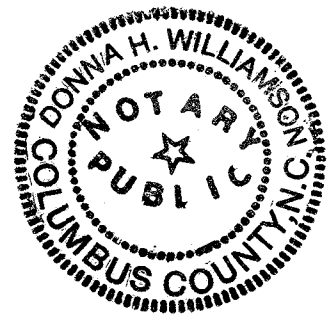

Columbus County, North Carolina
I, Donna H. Williamson Notary Public do hereby certify that DAVEY G. WILLIAMSON personally appeared before me and acknowledged the due execution of the foregoing map. Witness my hand and seal this 24 day of July 1992. My commission expires Aug. 19 1992
Donna H. Williamson
Notary Public

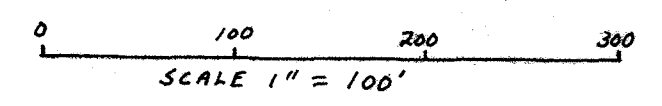
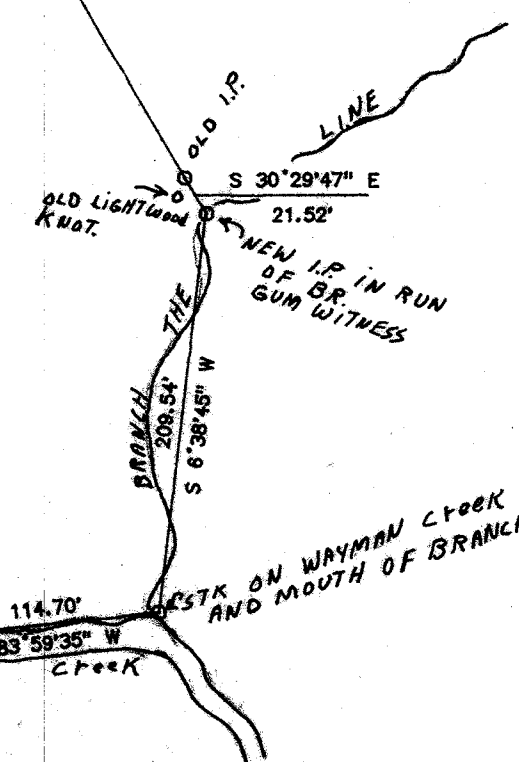

PB 54 PG 94

Book 54 Page 94