

1. LOCATION OF THIS TRACT IN THE STATE OF NORTH CAROLINA
 2. POSITION OF THIS TRACT AS LOCATED FROM AN AERIAL PHOTOGRAPH
 3. AREA OF THIS TRACT

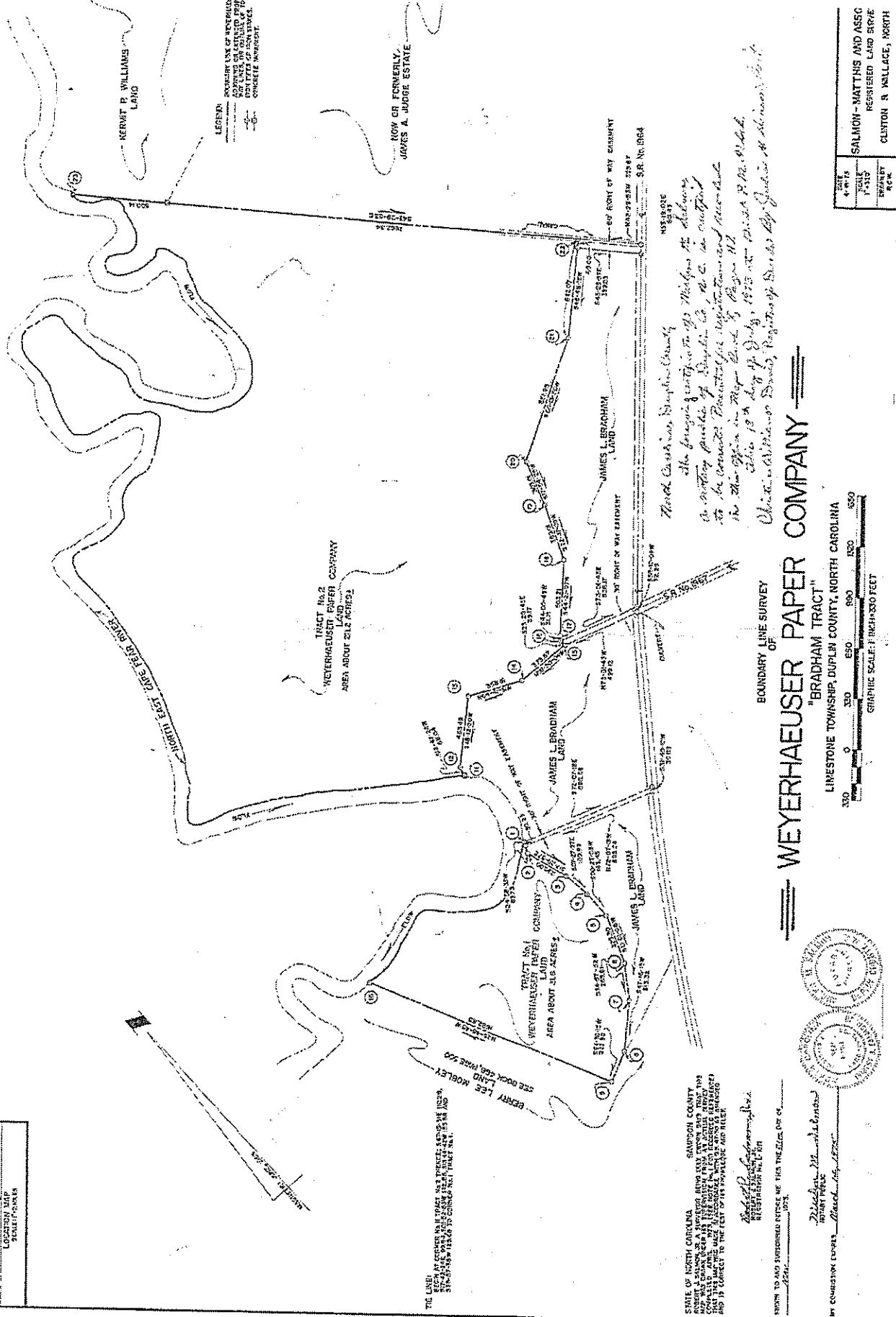
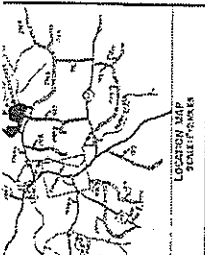

DATE	APPROVED	REGISTERED
APR 15 1935	APR 15 1935	APR 15 1935
REGISTER	REGISTER	REGISTER
BOOK	BOOK	BOOK
PAGE	PAGE	PAGE

SALMON-MATTHEWS AND ASSC
 REGISTERED LAND SURVEYOR
 CLYTON R WALLACE, NORTH

BOUNDARY LINE SURVEY OF "BRADHAM TRACT"
 LINSTONE TOWNSHIP, DUPLIN COUNTY, NORTH CAROLINA

WYERHAEUSER PAPER COMPANY

THESE ARE THE ORIGINAL RECORDS OF THE SURVEY MADE BY JAMES L. BRADHAM, SURVEYOR, IN THE YEAR 1864, AND THE SAME ARE HEREBY RECORDED FOR THE PURPOSE OF PRESERVING THE SAME AS A PUBLIC RECORD.

THIS SURVEY WAS MADE BY JAMES L. BRADHAM, SURVEYOR, IN THE YEAR 1864, AND THE SAME ARE HEREBY RECORDED FOR THE PURPOSE OF PRESERVING THE SAME AS A PUBLIC RECORD.

THIS SURVEY WAS MADE BY JAMES L. BRADHAM, SURVEYOR, IN THE YEAR 1864, AND THE SAME ARE HEREBY RECORDED FOR THE PURPOSE OF PRESERVING THE SAME AS A PUBLIC RECORD.

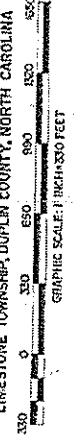

STATE OF NORTH CAROLINA
 DUPLIN COUNTY
 I, JAMES L. BRADHAM, SURVEYOR, DO HEREBY CERTIFY THAT THE ABOVE IS A TRUE AND CORRECT COPY OF THE ORIGINAL RECORDS OF THE SURVEY MADE BY JAMES L. BRADHAM, SURVEYOR, IN THE YEAR 1864, AND THE SAME ARE HEREBY RECORDED FOR THE PURPOSE OF PRESERVING THE SAME AS A PUBLIC RECORD.

WITNESSED MY HAND AND SEAL IN THE CITY OF WASHINGTON, D. C., THIS 15TH DAY OF APRIL, 1935.

JAMES L. BRADHAM
 SURVEYOR

RECORDED BY
 SALMON-MATTHEWS AND ASSC
 REGISTERED LAND SURVEYOR